



Salsa Arc de Tri-oomph™ Brake Booster

WARNING

Do not try to install this item if you do not understand the instructions or if you do not have the proper tools. Please have this item installed by the professional, experienced mechanic at your local bike shop. Remember, these are your brakes!

1. Slide brake arms onto appropriate brake mounting boss.
*Note: Brake mounting bosses must be between 73mm and 100mm apart (center to center) for the Arc de Tri-oomph to fit.
2. Slide mounting bolt with washer through each hole on the Arc de Tri-oomph with the heads of the bolts facing the same direction as the Salsa logo. Slide a shouldered spacer onto each bolt with the small end facing away from the Arc de Tri-oomph. An additional spacer inserted between the Arc de Tri-oomph and the shouldered spacer may be necessary for the Arc de Tri-oomph not to interfere with the brake arms' movement. For best performance, use as few spacers as possible to position the Arc de Tri-oomph as close as possible to the brakes.
*Note: Two sets of mounting bolts are supplied with the Arc de Tri-oomph. Use the longer bolts unless they bottom out before tightening down on the Arc de Tri-oomph. This will ensure proper thread engagement and prevent damage to the brake mounting bosses. Achieving the proper combination of spacers and bolts may take a few tries. Taking time now to get it right will pay off later (i.e. when you are riding your bike).
3. Loosely install the assembly onto the bike by threading the mounting bolts into the brake mounting bosses. Do not tighten the bolts yet.
4. Center the Arc de Tri-oomph over the brake mounting bosses and tighten each bolt to a torque of 45-60 in-lbs.
5. Check to make sure the Arc de Tri-oomph does not interfere with the movement of the brake arms.
6. Check assembly for tightness before each ride.

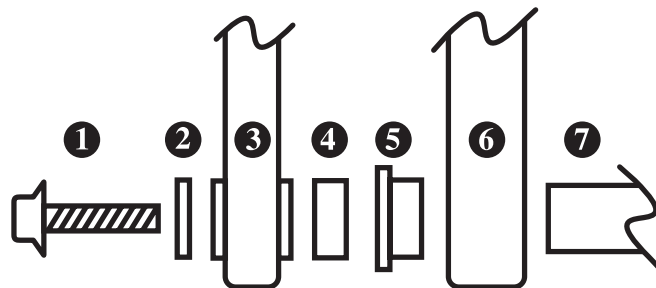

1. Mounting Bolt
2. Washer
3. Arc de Tri-oomph
4. Spacer
5. Shouldered Spacer
6. Brake Arm
7. Brake Mounting Boss (part of frame)

Salsa Cycles Limited Lifetime Warranty

This Salsa® product is warranted against defects in materials and workmanship for the lifetime of the product subject to the limitations detailed below. This limited warranty is expressly limited to the repair or replacement of the original product, at the option of Salsa Cycles, and is the sole remedy of the warranty. This limited warranty applies only to the original purchaser of the Salsa® product and is not transferable.

In no event shall Salsa Cycles be liable for any loss, inconvenience or damage, whether direct, incidental or consequential or otherwise resulting from breach of any express or implied warranty or condition, of merchantability, fitness for a particular purpose, or otherwise with respect to this product except as set forth herein.

This warranty does not cover the following:

- damage due to improper assembly or follow-up maintenance or lack of skill, competence or experience of the user or assembler
- products that have been modified, neglected, used in competition or for commercial purposes, misused or abused, involved in accidents or anything other than normal use
- damage or deterioration to the surface finish, aesthetics or appearance of the product
- normal wear and tear
- labor required to remove and/or refit and re-adjust the product within the bicycle assembly

This warranty gives the consumer specific legal rights, and those rights and other rights may vary from state to state.